

# PLANET



Oceaneering: Advancing Further into the Digital Future



Greater ROV Control and Automation



Multibeam Sonar Performance



The Gladiator Control System

# 12

The magazine of choice for Subsea Construction and ROV Professionals

ISSUE  
Q3 / 2017

# TABLE OF CONTENTS

<b>04</b>	Welcome to ROV Planet
<b>07</b>	Oceaneering: Advancing Further into the Digital Future
<b>10</b>	JANUS – The First Digital Underwater Communications Standard
<b>13</b>	New Technologies Drive Greater ROV Control and Automation
<b>17</b>	SMD Atom for Submarine Rescue Operations
<b>21</b>	Tritech Multibeam Sonar Performance
<b>25</b>	Event Review – Oceans’17 Aberdeen
<b>26</b>	Poster
<b>28</b>	Event Preview – SPE Offshore Europe
<b>29</b>	Trelleborg Combining Glass & Air to Create Custom Buoyancy
<b>33</b>	The Gladiator Control System
<b>36</b>	Technology Focus – Subsea Lights: Multiray LED Sealite – Do More, See More
<b>39</b>	Technology Focus – Subsea Lights: Deep-Sea Light Strobe
<b>41</b>	ROVs Using Powerline Communications
<b>45</b>	The RUD ROV Hook – An Innovative Approach to Safe Subsea Lifting Operations
<b>47</b>	ROV Pilot Tech Training – High Voltage and Electronics

**EDITOR-IN-CHIEF**  
Richie Enzmann

**COPY EDITOR**  
Will Grant

**CONTRIBUTORS**  
Richie Enzmann, Rod Larson,  
Dr. John Potter, Don Pickering,  
Victoria Bosi, Amy McGuiness, Scott McLay,  
Bob Kelly, Gary McConnell, Ladd Borne,  
Andrew Parker, Michael Propp

**DESIGN & LAYOUT**  
Milan Farkas

**SPECIAL THANKS TO**  
Bill Mallin, Christina Tran, Stephen Gibb,  
John Benson, David Brown, Isabel Dias,  
Victor Sepuvela, Cristian Gurgu,  
Nick Rettie, Erica Paulson, Eric Chapman,  
Robert Marsh, Trevor Bayfield,  
Scott Johnston, Neil Jackson, Lisa Wu,  
Kevin Edwards, Mike Bisset, Kim Carter,  
Tony Callaghan, Doowon Choi,  
David Jaramillo, Karl Scheuermann,  
Andrejs Cernavskis

Oceaneering  
Balmoral Offshore  
DWTEK  
Sonardyne  
SMD  
Trelleborg  
Digital Edge Subsea  
QSTAR Subsea Solutions  
EPRONS  
ToolTec  
Zetechtics  
BluHaptics  
STR Subsea  
Arctic Rays  
NATO STO CMRE  
Valeport  
Tritech  
ROVQUIP  
Panolin  
DeepSea Power & Light  
Aleron Subsea  
Echologger  
Astute Electronics  
Adaptive Networks  
RUD Ketten  
Maxon Motor

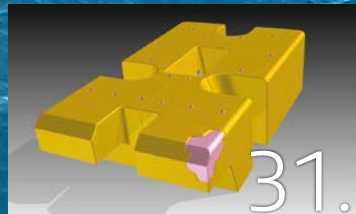

# MULTIRAY™ LED SEALITE®.

## DO MORE, SEE MORE

by DeepSea Power & Light

---

DeepSea Power & Light (DSPL) released the LED SeaLite in 2016 to provide high configurability and the quality that DSPL is known for at competitive pricing. The LED SeaLite incorporates compact design, high efficiency electronics, and optional SeaSense™ serial command control with a wide range of analog control options.

---

The LED SeaLite has many configuration combinations. Features include up to 10,000 lumens output in both AC and DC driver configurations; aluminum or titanium housings; a sapphire port with a 6,000 m or 11,000 m depth rating, or an acrylic port with 4,000 m depth rating; and wide, flood, or spot single beam angle configurations. This subsea LED light is field serviceable with no soldered wire connections or specialized tools required. DSPL's broad connector compatibility coupled with the option to fit a classic mounting collar or compact saddle bracket makes integration simple.

Three LED SeaLite models are currently available: LSL-1000, LSL-2000, and the new Multiray LSL-2025. The Multiray LSL-2025 model introduces compelling technology that configures a single luminaire with two sets of LED sources that can be operated independently or in tandem, each with its own color and beam pattern.



The LED SeaLite has many configuration options to address and adapt to market needs. (Courtesy of DeepSea Power & Light)

## MULTIRAY: DESIGNED FOR VERSATILITY AND HIGH PERFORMANCE

In the LSL-2025, the light engine is divided into two arrays of LEDs. Each array can be populated with a different color of LED source, selected from: whites, blues, greens, reds, and other colors; along with ultraviolet and infrared non-visible emitters. LED arrays can be fit with a choice of optics to produce a variety of beam patterns from a 115° wide flood to a 28° narrow spot. Two different light engine configurations exist: an 8-LED and a 32-LED. In both configurations, each array occupies half of the LED positions within the light engine (Figure 1). These layouts accommodate a wide variety of LED source and optic combinations.

Each array is connected to an output channel on the internal DC-DC constant current driver through a switching circuit expansion board. Intelligent microprocessor control allows the driver to power each array, and in some configurations, both arrays simultaneously. The control design allows the driver to power each array and to manage each channel's operation (Figure 2). Three operating modes are available: channel 1, channel 2, or channels 1 and 2 combined (Figure 3).

The robust control logic in the Multiray driver ensures that the LED arrays operate at maximum performance, and manage potential electrical differences in each array of LEDs. The Multiray driver adapts dynamically when switching active channels for different forward voltage or forward current characteristics. The combined operating mode is available for arrays with matching forward voltage characteristics. This mode is generally limited to white LEDs which typically have the same forward voltage characteristics independent of the color temperature or other spectral characteristics.

In cases where LEDs have a higher maximum drive current than others, the driver changes the peak drive current when switching between output channels. Full dimming and light controls are maintained for each array when switching between operating modes.

## CONTROL METHODS WITH THE OPERATOR IN MIND

Two control options are available for Multiray LED Sealites: DSPL's SeaSense serial commands and power cycling. SeaSense uses human-readable character commands and syntax for real-time control over standard EIA-485 and EIA-232 serial communication interfaces, and is available with the LED SeaLite and other select DSPL products. SeaSense provides the most flexibility for controlling Multiray driver channels. Using SeaSense allows Multiray LED lights to:

- | Select an operating mode directly or cycle through enabled modes.
- | Assign Multiray operating modes and dimming levels to any of the sixteen user presets.
- | Change the max power limit on an operating mode and dimming level.

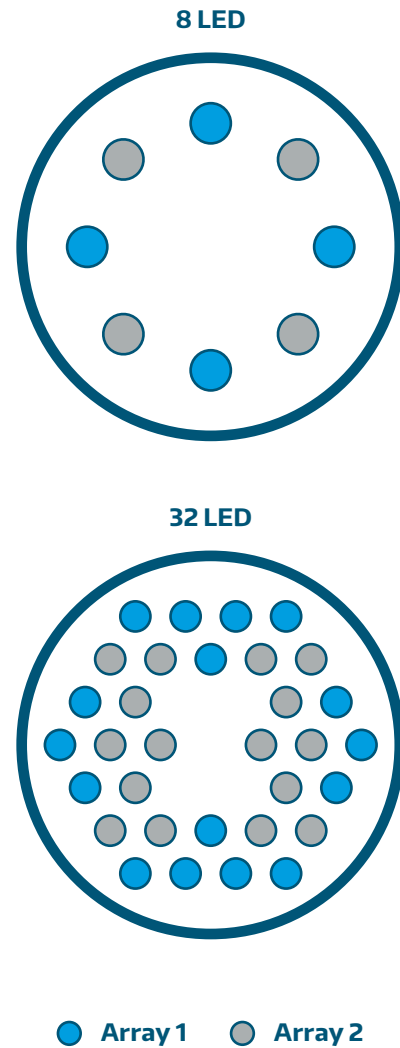

### LED SeaLite® Multiray LED Array Layout

Fig. 1: Multiray is available with 8 or 32 LEDs in the light engine. The light engine is divided into two arrays of LEDs each of which occupies half of the available positions in a balanced layout. (Courtesy of DeepSea Power & Light)

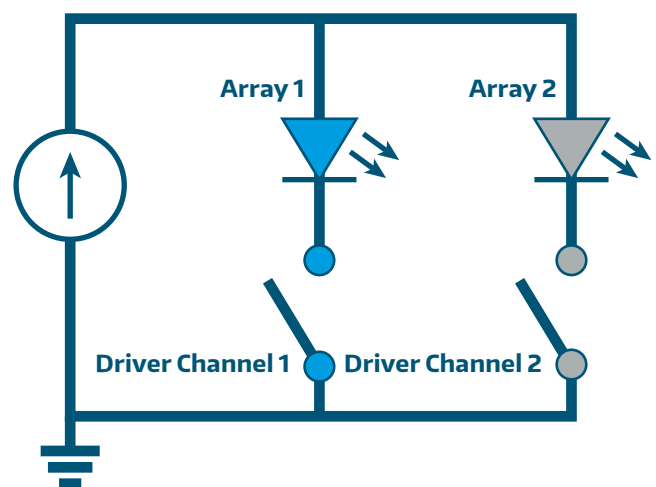

Fig. 2: Each array is controlled separately through a driver channel. The driver control switches between the color and beam pattern combinations configured in each light engine array. (Courtesy of DeepSea Power & Light)

MULTIRAY OPERATING MODES		
OPERATING MODE	CHANNEL 1	CHANNEL 2
Array 1	ON	OFF
Array 2	OFF	ON
Combined	ON	ON

Fig. 3: The arrays operate separately or combined. The combined operating mode is available in configurations where array forward voltages match. (Courtesy of DeepSea Power & Light)

For systems without serial control, the power cycling control option for Multiray is a straightforward method to change the operating mode. Power cycling is compatible with any of the analog and serial dimming control methods to make retrofitting existing systems with Multiray luminaires easy. Turning off power to an LSL-2025 and turning it back on within three seconds advances the operating mode from array 1 to array 2, then from array 2 to combined (if available), and then from combined back to array 1.

### MULTIRAY IN USE

Multiray LED SeaLites can combine the functions of two fixtures in a single luminaire (see Figure 4 for common configurations). Integrating an LSL-2025 enables operators to expand vehicle capability while saving space, avoiding downtime for switching luminaires, and mitigating costs for multiple luminaires.

Multiray allows more control for optimal imaging when operators must adjust settings in changing subsea environments. While a traditional luminaire only offers the option to dim lighting, the LSL-2025, with its combined LED

sources and optics, provides a range of options to minimize backscatter and optimize visibility in turbid environments. The operator might use a daylight white LED source to survey a location and switch to a warm white, color, or high CRI source to better view a biological sample or corrosion site.

A Multiray luminaire configured with monochromatic LEDs enables a system to perform more than one job function on a single deployment when different LED colors are required. A single luminaire equipped with a green LED array and a blue LED array can perform leak detection of either rhodamine or fluorescein based dyes saving time and cost.

Configuring Multiray with beam pattern combinations supports multiple observation tasks. Operators can better control where they put light with an LSL-2025 flood and spot beam pattern configuration. When used along with a zoom camera, this light combination gives the operator the ability to follow the camera's field of view and place the light where it is most needed by switching from a flood beam to a spot beam when the camera zooms onto a target.

### LED SEALITE AND MULTIRAY: DO MORE WITH LESS

DeepSea Power & Light provides subsea technology that maximizes performance, durability, and value. The LED SeaLite exemplifies these traits with a robust design, performance efficiency, and affordable implementation. With a subsea Multiray LED light functioning as more than two lights combined into one, projects can count on the reliability of the LED SeaLite, realize lower overall equipment costs, minimize downtime, and gain versatility through increased luminaire flexibility and operator control.

ARRAY 1	ARRAY 2	CONFIGURATION
Daylight White 75° Flood	Daylight White 115° Wide <sup>1</sup>	DW00-D02
Warm White 75° Flood	Warm White 115° Wide <sup>1</sup>	WW00-D02
Daylight White 40° Spot	Daylight White 75° Flood	DW00-D01
Warm White 40° Spot	Warm White 75° Flood	WW00-D01
Daylight White 75° Flood	Warm White 115° Wide <sup>1</sup>	DC01-D02
Warm White 75° Flood	Daylight White 115° Wide <sup>1</sup>	DC02-D02
Daylight White 40° Spot	Warm White 75° Flood	DC01-D01
Warm White 40° Spot	Daylight White 75° Flood	DC02-D01
Daylight White 75° Flood	Green <sup>3</sup> 75° Flood	DC03-FLD
Daylight White 75° Flood	405nm Ultraviolet <sup>2</sup> 40° Spot	DC04-D01

<sup>1</sup> Must use acrylic port   <sup>2</sup> Must use sapphire port   <sup>3</sup> Contact sales for red, blue, and other color options

Fig. 4: Base Multiray configurations for the LSL-2025. Contact sales for specific configuration needs. (Courtesy of DeepSea Power & Light)